



# PRO RAPID TAPE



DUNLOP PRO RAPID TAPE is a self-adhesive sealing tape that provides a waterproofing seal between the surface joints of the floor and wall, under shower grates and outlets in wet areas such as bathrooms, kitchens and laundries. Use in conjunction with DUNLOP PRO RAPID WATERPROOFING MEMBRANE for a rapid total waterproofing system and tiling can commence in 4 hours. Using this tape in conjunction with the DUNLOP PRO RAPID WATERPROOFING MEMBRANE meets the standard for waterproofing according to the Australian Building standards.

## SUITABLE SURFACES

Internal fibre-cement wall sheet, compressed fibre-cement sheets, wet area grade plasterboard, concrete (cured for min. 28 days), renders and screeds (cured for min. 7 days), plywood and internal AAC blocks and panels.

## MINIMUM AREAS TO WATERPROOF

Always refer to the local government regulations including AS3740-2010 for the requirements of any waterproofing project.

## SURFACE PREPARATION

Surfaces must be sound and dry and all sheeting materials must be installed to manufacturer's instructions. Remove all contaminating materials such as dust, oil, paint and curing compounds. Prime all areas to be waterproofed with DUNLOP PRIMER & ADDITIVE according to the instructions on the container and datasheet. AAC blocks will require two coats of DUNLOP PRIMER & ADDITIVE. Plastic (PVC) fittings should be wiped down with methylated spirits and treat metal surfaces with a suitable metal primer.

## COVERAGE

The DUNLOP PRO RAPID TAPE will cover up to 15m.

## TILING

Prior to tiling the application of DUNLOP PRO RAPID WATERPROOFING MEMBRANE is required as part of the Pro Rapid Waterproofing system.

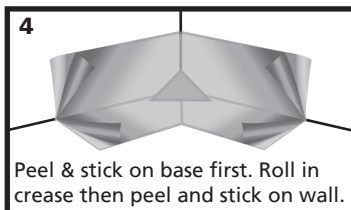
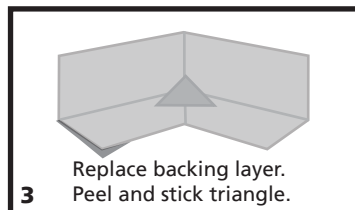
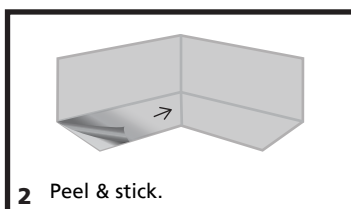
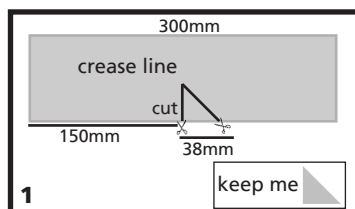

## How to form and install a corner detail for all 90° corner joints

### Forming:

**1.** Cut to 300mm in length. Cut up centre of tape to 2mm before the middle crease line. Cut again at 45° and remove triangular piece. **2.** Peel and stick left base section under the right base section to form a 90° corner. Replace backing layer on exposed left base "sticky" face. **3.** Stick triangular section into the internal corner just formed ensuring the internal corner is covered, press down firmly.

### Installation:

Allow primer to thoroughly dry before installation of tape.

**4.** Peel back base backing layers and position exactly then stick down into corner. Using a roller, roll along the right angle creases. Peel back top backing layer and stick down, press down firmly.

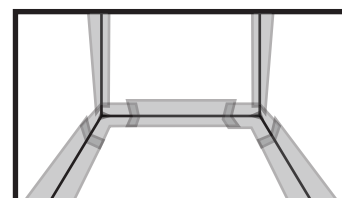
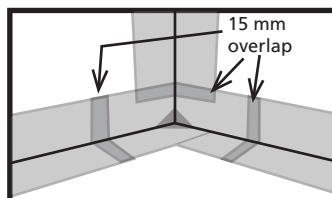

## How to prepare and install horizontal and vertical tape sections:

Measure and cut the length between the corner sections plus allow a minimum of 15mm overlap on both ends (e.g length = 1.8m + 15mm (left) + 15mm (right) = 1.83m) or 80mm above the shower rose for the vertical section.

### Installation:

**1.** Peel back white base backing layer, position exactly and stick down, with a minimum 15mm overlap. **2.** Using a roller, roll along the right angle crease. **3.** Peel back top backing layer and stick down, press down firmly.

Note: There is no requirement for the use of neutral cure silicone as a bond breaker to joints when using the DUNLOP EXPRESS TAPE, as this tape is highly flexible.

For more detailed information on how to prepare and install shower joints, grates and tap outlets and aluminium or PVC shower or door stop angles visit [www.dunlopdiy.com](http://www.dunlopdiy.com) to watch a full installation video.

After application of the DUNLOP PRO RAPID TAPE, apply



# PRO RAPID TAPE

DUNLOP PRO RAPID WATERPROOFING MEMBRANE as per label instructions and datasheet.

## PRECAUTIONS

Before any substrate preparation, installation or finishing methods relating to DUNLOP product are undertaken, please be aware of any potential risks and use appropriate PPE (personal protective equipment). This may involve contacting substrate manufacturers for Safety Data Sheets.

## DISCLAIMER

The technical details, recommendations and other information contained in this data sheet are given in good faith and represent the best of our knowledge and experience at the time of printing. It is your responsibility to ensure that our products are used and handled correctly and in accordance with any applicable Australian Standards. Our instructions and recommendations are only for the uses they are intended. Users are advised to confirm that this product is suitable for their application and conforms with the specifications of the system being employed and other products in that system. We also reserve the right to update information without prior notice to you to reflect our ongoing research and development program. Country specific recommendations, depending on local standards, codes of practice, building regulations or industry guidelines, may affect specific installation recommendations. The supply of our products and services is also subject to certain terms, warranties and exclusions, which may have already been disclosed to you in prior dealings or are otherwise available to you on request. You should make yourself familiar with them.

This datasheet was issued in September 2020 and is valid for 3 years, unless updated sooner. Always refer to [www.dunlopit.com](http://www.dunlopit.com) for the latest technical data from ARDEX